

**LEGEND**

- STONE WALL
- PROPERTY LINE
- BLDG. SETBACK LINE
- CONTOUR LINE (5')
- CONTOUR LINE (10')
- TREE LINE
- SEASONAL BOUNDARY LINE
- SOIL BOUNDARY LINE
- VERY POORLY DRAINED WETLANDS
- POORLY DRAINED WETLANDS
- UTILITY POLE
- IRON PIPE FOUND (I.P.F.)
- STONE BOUND FOUND (S.B.F.)
- DRILL HOLE SET (O.H.S.)
- 4" x 4" x 36" STONE BOUND SET (S.B.S.)

**LEGEND**

- CONTOURS OF AREA # 2 FROM STATE HIGHWAY PROJECT NUMBER LS 1873 (1)
- CONTOURS OF AREA # 2 FROM STATE HIGHWAY PROJECT NUMBER LS 1873 (1)

STATE OF N.H. D.O.T.  
INTERCHANGE AND DIVISION OFFICES  
J.O. MORTON BUILDING, HAZEN DRIVE  
CONCORD, NH 03301

ROW RESERVED FOR FUTURE  
ROAD TO TOWN LAND AND ABUTTERS  
280,192 SQ. FT.  
0.60 ACRES

TAX MAP 10, LOT 28  
FRANCES CHANDONNET  
55 KAVIA DRIVE  
CANDA, N.H. 03034

STATE OF N.H. D.O.T.  
INTERCHANGE AND DIVISION OFFICES  
J.O. MORTON BUILDING, HAZEN DRIVE  
CONCORD, NH 03301

FORMERLY PART OF  
TAX LOT # 13-2  
DEEDED TO THE STATE  
(VOL.# 794 PG.# 94)

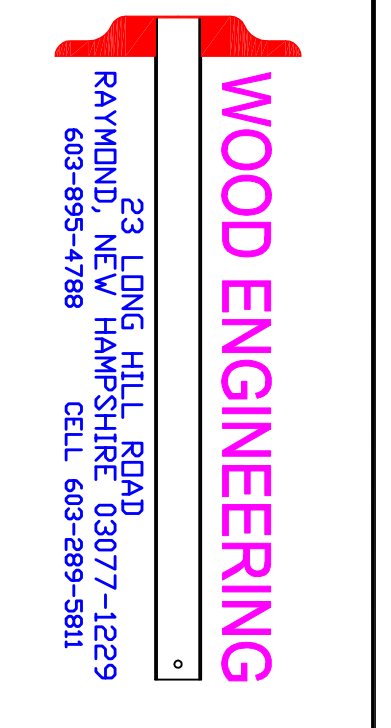
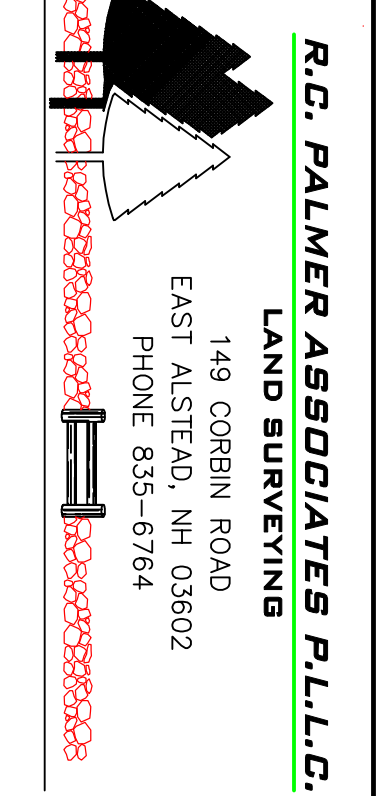

NO.	DATE	REVISION	BY

THIS PLAN IS APPROVED IN ACCORDANCE WITH THE TOWN OF HOOKSETT SUBDIVISION REVIEW REGULATIONS.

DATE: \_\_\_\_\_  
SIGNED: \_\_\_\_\_

OVERALL SITE PLAN OF  
"MERRIMACK LANDING"  
PREPARED FOR KEYLAND PROPERTIES, L.L.C.  
CORNER OF ROUTE 3A &  
HACKETT HILL ROAD, HOOKSETT  
TAX MAP # 13, TAX LOT # 1 & 2  
OCTOBER 23, 2007